



PATSON PARKHOUSE Apartment

1. Floor Plan
2. Price List
3. Specifications
4. Key Plan

Site Address: Door No.4, Srinivasa Street, Radha Nagar, Chromepet, Chennai 600 044 (Next to PATSON SUNSHINE)

Office address : #353, Shop no: S, Amala Annai Church Complex, GST Road, Chromepet, Chennai – 600 044.

Email: patsonbuilders@gmail.com;

website: www.patsonbuilders.com

Cell : 99625 37799/99625 12346

POSSESSION : MARCH' 2025



Note : COMMON AREA =21%



BUILDINGS DO HAVE A SOUL, THAT COULD RESPOND TO THE MOOD YOU ARE IN, BE IN TUNE TOWHAT YOU ARE DOING

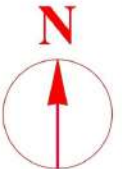
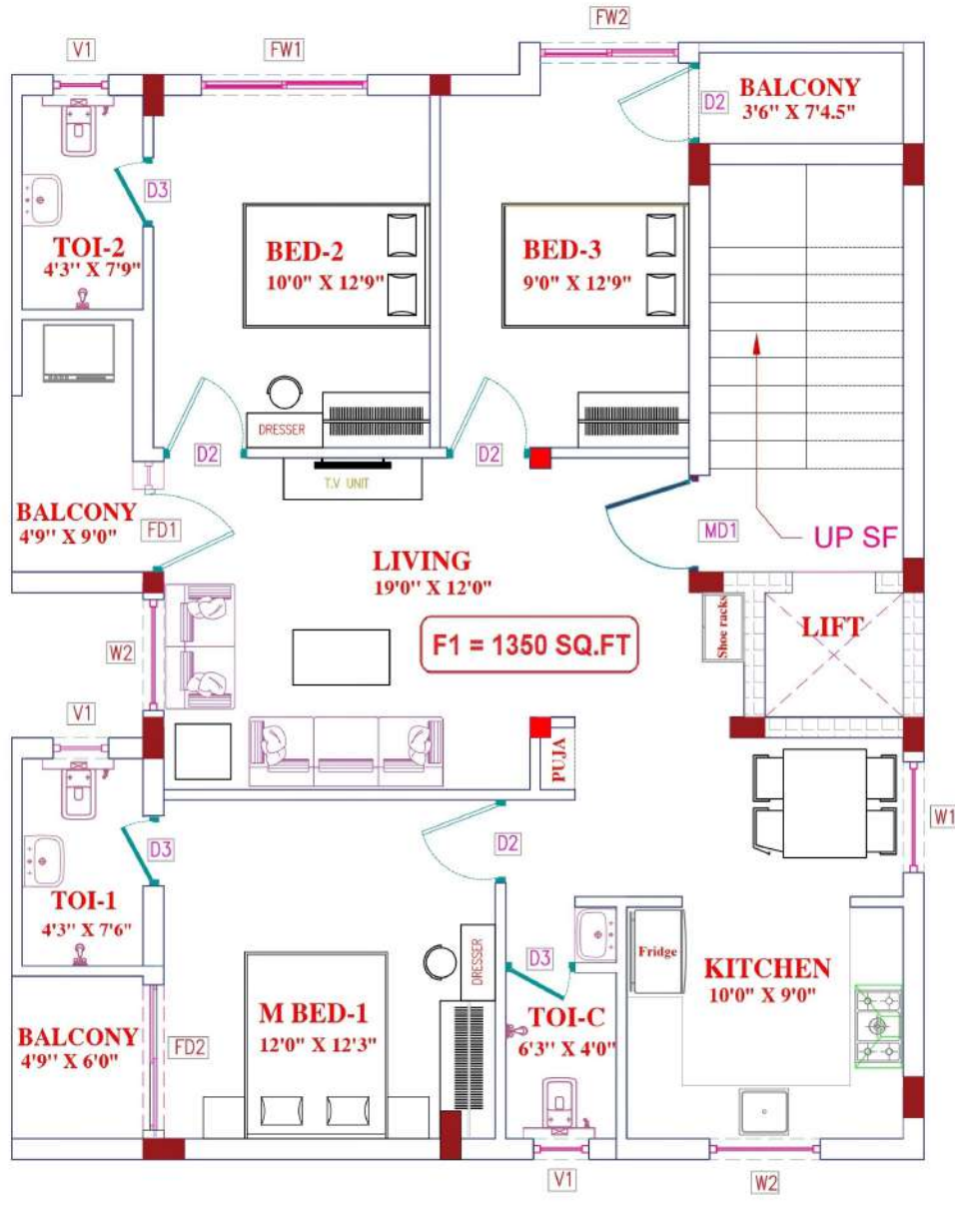

PATSON PARKHOUSE

FIRST FLOOR PLAN

Note : COMMON AREA =21%



BUILDINGS DO HAVE A SOUL, THAT COULD RESPOND TO THE MOOD YOU ARE IN, BE IN TUNE TOWHAT YOU ARE DOING

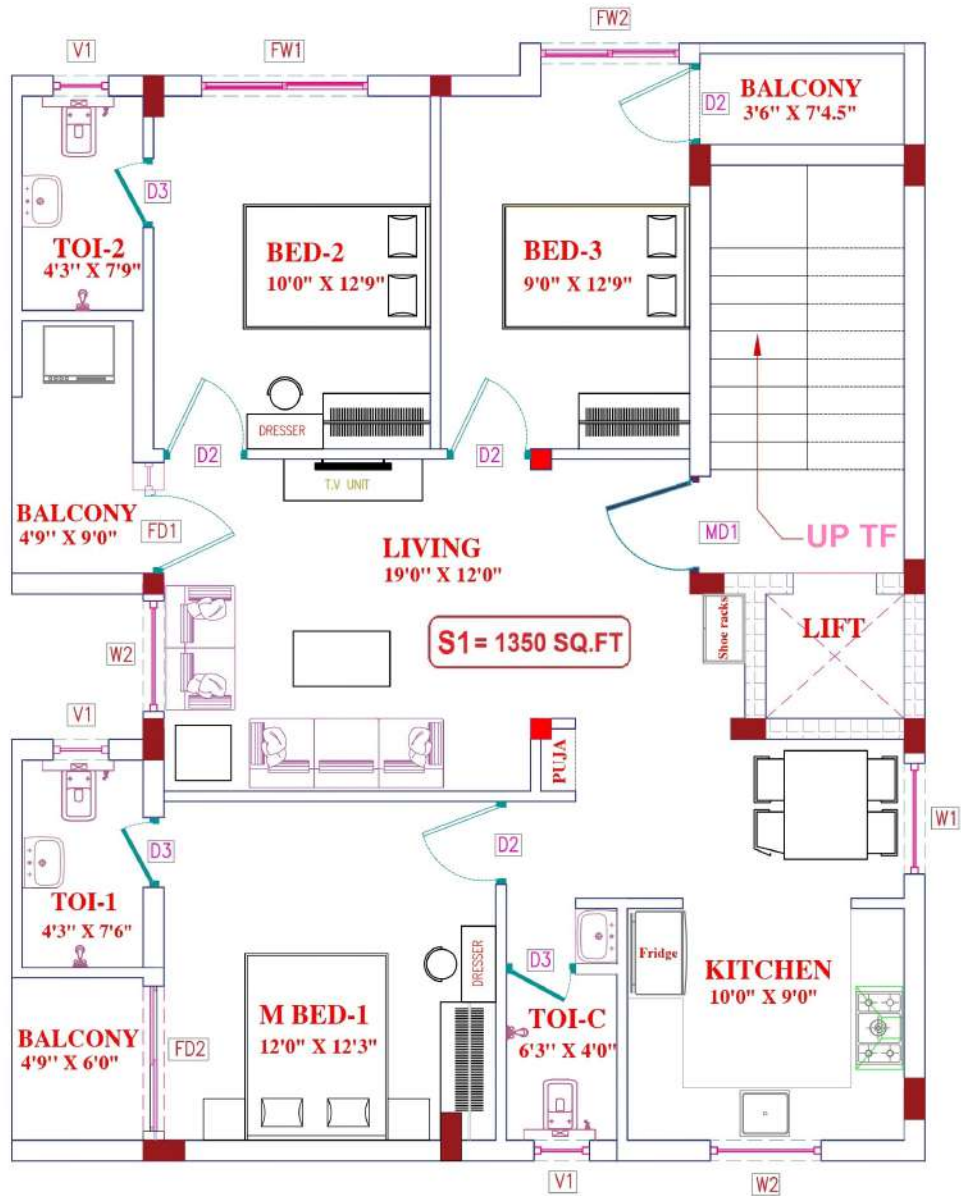

PATSON PARKHOUSE

SECOND FLOOR PLAN

Note : COMMON AREA = 21%



BUILDINGS DO HAVE A SOUL, THAT COULD RESPOND TO THE MOOD YOU ARE IN, BE IN TUNE TOWHAT YOU ARE DOING

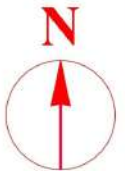
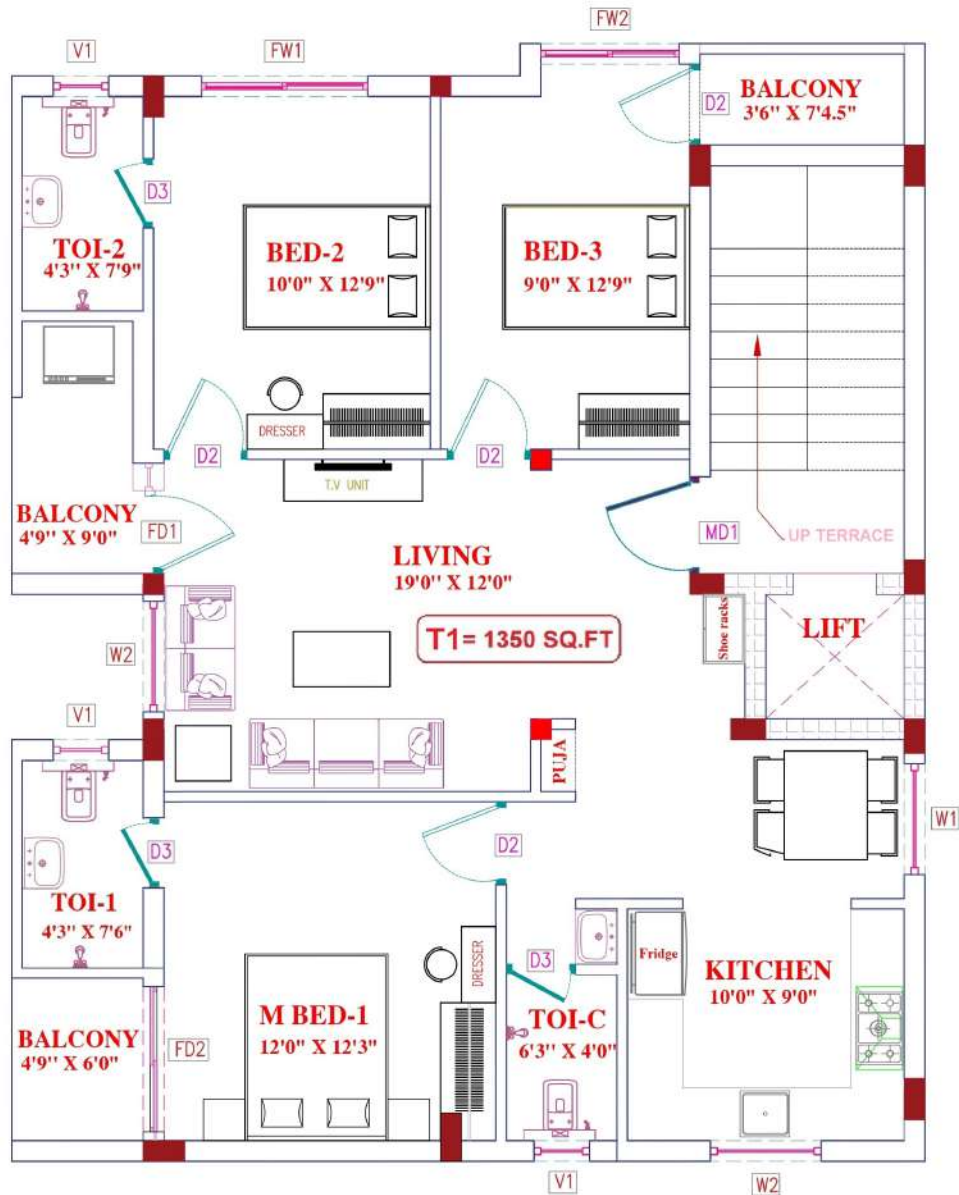

PATSON PARKHOUSE

THIRD FLOOR PLAN

Note : COMMON AREA =21%

PATSON PARK HOUSE Apartment

Srinivasalu Naidu Street Chromepet **PRICE DETAILS** Date:01.03.2025

DETAIL/ FLAT NAME	F1 3 BHK	S1 3 BHK	T1 3 BHK
SUPER BUILT - UP AREA	1350	1350	1350
UDS SHARE	497	497	497
FACING	EAST	EAST	EAST
RATE per SQ.FT	7,500 /-	7,500 /-	7,700 /-
EB Charges	75,000	75,000	75,000
WATER Charges	30,000	30,000	30,000
UGD Charges	30,000	30,000	30,000
REG 7% Charges*	8,40,000	8,40,000	8,79,000
GST 5% Charges*	6,00,000	6,00,000	6,10,000
TDS 1% Charges*	1,20,000	1,20,000	1,22,000
Covered CAR Parking - 2 Nos	5,00,000	5,00,000	5,00,000
TOTAL	1,23,20,000	1,23,20,000	1,26,41,000

Note: Price quoted above are subject to change every 30 days according to its development.*Will Change according to agreement value; T1 = Ceiling height -13'0"

SPECIFICATIONS

Foundation

- ❖ Suitable Open Foundation will be provided based on Soil conditions under structural engineer guidance

Structure

- ❖ RCC framed for beams, slabs, lintels, etc
- ❖ AAC Block work 9" Outer wall and 4" for Inner wall
- ❖ Cupboard using Kadappa (4'0" length) in all the bed room
- ❖ Plastering: Rough finish at outer, smooth finish at inner
- ❖ Ceiling Height – 11'0" (Eleven Feet)

Kitchen Platform

- ❖ Kitchen platform will be of Black Galaxy Granite 24" depth at a height of 2'6" from floor level
- ❖ Diamond stainless steel single bowl sink with single drain board. (18"X24")

Electrical and Plumbing

- ❖ Modular switches – GM Switches
- ❖ ORBIT wires
- ❖ A/C Point Hall & Bedrooms
- ❖ 5Amps at every switch box
- ❖ 6nos of 15Amps provided

- ❖ TV point in all bedrooms and hall
- ❖ DIVERTER with cold water and hot water provided with shower (JAGUAR)
- ❖ PVC pipe for External & CPVC pipe for Internal Concealed pipe
- ❖ Three ceramic wash basin
- ❖ THREE WESTERN closet (JAGUAR)
- ❖ Switch points as per customer choice.

DOORS

- ❖ African Teak 1st Quality Main Door 3'6"X8'0" with polishing
- ❖ Other doors -2nd Quality Teak frame with premium Flush doors 3'0"X8'0"
- ❖ Toilet – WPC door
- ❖ Windows – UPVC Sliding window with mesh and grill provided
- ❖ French window in UPVC sliding connecting Balcony
- ❖ Grill – MS Square 8mm

Flooring

- ❖ 4x2 Vitrified Tiles for Living Room as well as Bedroom @ Rs.75/ sq.ft, Whereas Toilet 8' height Wall Tiles and Kitchen 2' ht Wall Tiles provided-Rs.50/sq.ft)

For Staircase

- ❖ Granite stone will be fixed for flooring and SS Steel pipe will be fixed as hand railing

For Car parking

- ❖ Paver blocks will be laid throughout by marking respective flat number in Yellow paint with Lights.

Painting

- ❖ Inner wall - 2 coat Asian wall putty, 1 coat primer, 2 coat Royale Emulsion with roller finish
- ❖ Outer wall – 2 coat cement paint, 2 coat of ACE/ APEX Emulsion
- ❖ TEXTURE Paint at Front side/ Doors & Grill- Synthetic Enamel Paint

Weathering

- ❖ Cement flooring with top covered by 12"x12" weathering UV proof tiles.

False Ceiling With Lights // Complete Interior Package

Terrace Garden // CCTV 24 X 7

Video Door Phone // Automatic Water Controller

Automatic Lift -6 Passengers – upto Terrace

Metro Water Sump - 4000 litres // Bore Sumps – 6000 litres

Pressure Pump // Metro Over Head Tank // Bore Over Head Tank

COMMON AREA – BACK UP

